



CONFERENCE



	BRIERLEY ROOM	HOUGHTON ROOM	CARLTON ROOM	CONFERENCE 1	CONFERENCE 2	CONFERENCE 4	CONFERENCE 5
DIMENSIONS (in metres)							
LENGTH	15m	15m	15m	9.9m	6.3m	10m	18m
WIDTH	24m	16m	8m	7m	4.5m	5.6m	7.5m
HEIGHT	5m	5m	5m	2.4m	2.4m	2.4m	2.4m
AREA	360m ²	240m ²	120m ²	69.3m ²	28.35m ²	56m ²	135m ²
CAPACITIES							
U-SHAPE	N/A	50	40	40	20	N/A	20 40
THEATRE	400	240	120	40	18	55	120
CLASSROOM	200	120	50	30	N/A	30	45
BOARDROOM	N/A	N/A	30	20	12	25	30
RECEPTION / BUFFET	340	180	100	50	N/A	50	100
BANQUET	300	180	100	N/A	N/A	N/A	100
DINNER DANCE	270	160	N/A	N/A	N/A	N/A	N/A
TECHNICAL INFORMATION							
CONTROLS IN ROOM	YES	YES	YES	YES	YES	YES	YES
BLACKOUT	YES	YES	YES	YES	YES	YES	YES
NATURAL DAYLIGHT	YES	YES	YES	YES	YES	YES	YES
13 AMP SOCKETS	14	10	4	6	4	6	6
FLOOR LEVEL - Ground (G) First (F)							
	G	G	G	F	F	G	G
OTHER							
TELEPHONE POINTS	6	2	2	1	3	2	4
AERIAL POINTS	1	1	1	1	1	0	0
AIR CONDITIONING	YES	YES	YES	YES	YES	YES	YES
TEMPERATURE CONTROL	YES	YES	YES	YES	YES	YES	YES
VEHICLE ACCESS	NO	NO	NO	NO	NO	NO	NO

CONFERENCE ROOMS

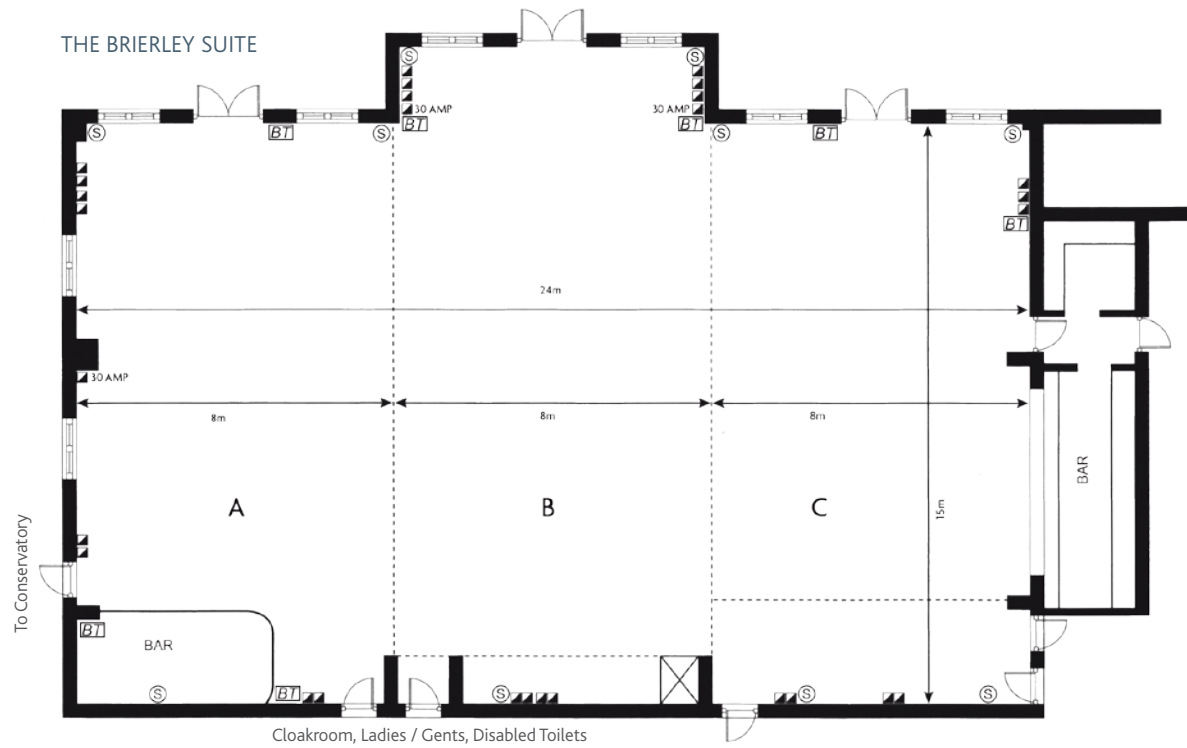

CONFERENCE ROOM 1

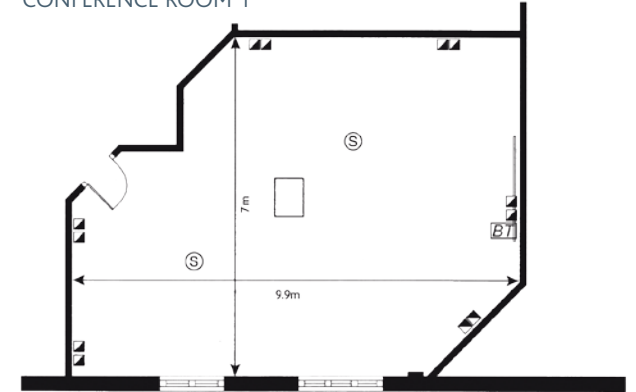

CONFERENCE ROOM 2

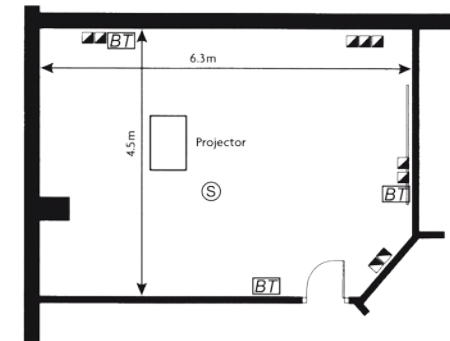

CONFERENCE ROOM 4+5

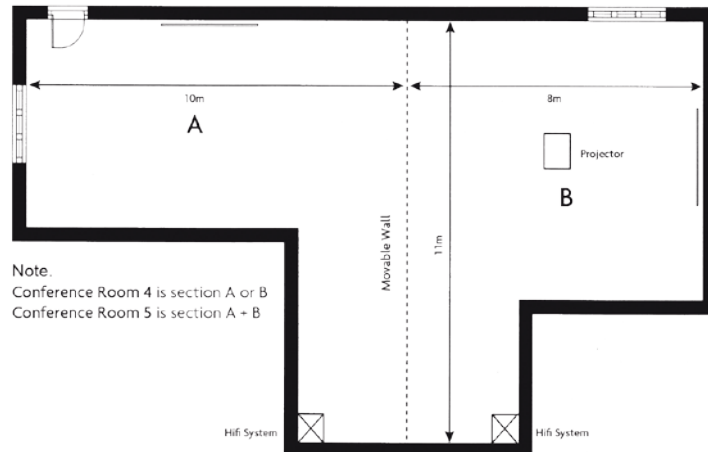

Note.
Conference Room 4 is section A or B
Conference Room 5 is section A + B

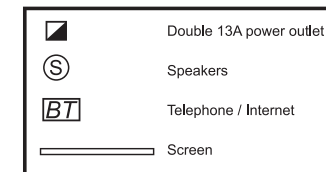

NOTE:

Houghton Room 4 is sections A+B or B+C of Brierley Suite
Carlton Room is section A or C of Brierley Suite

CONFERENCE ROOM HIRE RATES



	BRIERLEY ROOM	HOUGHTON ROOM	CARLTON ROOM	CONFERENCE 1	CONFERENCE 2	CONFERENCE 4	CONFERENCE 5
ROOM HIRE ONLY							
FULL DAY	£600	£350	£175	£140	£100	£140	£175
HALF DAY	£350	£200	£100	£80	£60	£80	£100
EVENING	-	-	-	£80	£60	£80	£100
EQUIPMENT HIRE		<i>(A standard rate of £10 per person, per day is charged for use of The Club fitness centre)</i>					
OVERHEAD PROJECTOR	£15						
6FT SCREEN	£15						
TV, VIDEO & DVD	£25						
FLIP CHART	£10						
LCD PROJECTOR	£50						
MICROPHONE	£25						
STAGE HIRE	£120						
DELEGATE RATES - PRICE PER PERSON							
DAILY	£32						
24 HR	£84						
SHARING	£64						
DELEGATE RATES - INC. FITNESS ALL DAY							
DAILY	£32						
24 HR	£84						
SHARING	£64						
SUNDRIES							
TEA, COFFEE, BISCUITS Per Person	£1.40						
4 COURSE EVENING MEAL Per Person	£20						

INCLUDED - In Delegate Package

- Room Hire (air conditioned)
- 3 x servings of Tea/Coffee & Biscuits
- Conference Lunch/Buffer
- 1 x Flip chart & 1 x Overhead Projector & Screen
- Complimentary Conference Paper & Pencil
- Iced Water & Cordial
- Accommodation & Breakfast (24hr delegate package)

ALL PRICES EXCLUDE VAT WHICH WILL BE CHARGED AT THE APPROPRIATE RATE.

