



# CONFERENCE



	BRIERLEY ROOM	HOUGHTON ROOM	CARLTON ROOM	CONFERENCE 1	CONFERENCE 2	CONFERENCE 4	CONFERENCE 5
<b>DIMENSIONS (in metres)</b>							
LENGTH	15m	15m	15m	9.9m	6.3m	10m	18m
WIDTH	24m	16m	8m	7m	4.5m	5.6m	7.5m
HEIGHT	5m	5m	5m	2.4m	2.4m	2.4m	2.4m
AREA	360m <sup>2</sup>	240m <sup>2</sup>	120m <sup>2</sup>	69.3m <sup>2</sup>	28.35m <sup>2</sup>	56m <sup>2</sup>	135m <sup>2</sup>
<b>CAPACITIES</b>							
U-SHAPE	N/A	50	40	40	20	N/A	20 40
THEATRE	400	240	120	40	18	55	120
CLASSROOM	200	120	50	30	N/A	30	45
BOARDROOM	N/A	N/A	30	20	12	25	30
RECEPTION / BUFFET	340	180	100	50	N/A	50	100
BANQUET	300	180	100	N/A	N/A	N/A	100
DINNER DANCE	270	160	N/A	N/A	N/A	N/A	N/A
<b>TECHNICAL INFORMATION</b>							
CONTROLS IN ROOM	YES	YES	YES	YES	YES	YES	YES
BLACKOUT	YES	YES	YES	YES	YES	YES	YES
NATURAL DAYLIGHT	YES	YES	YES	YES	YES	YES	YES
13 AMP SOCKETS	14	10	4	6	4	6	6
<b>FLOOR LEVEL - Ground (G) First (F)</b>							
	G	G	G	F	F	G	G
<b>OTHER</b>							
TELEPHONE POINTS	6	2	2	1	3	2	4
AERIAL POINTS	1	1	1	1	1	0	0
AIR CONDITIONING	YES	YES	YES	YES	YES	YES	YES
TEMPERATURE CONTROL	YES	YES	YES	YES	YES	YES	YES
VEHICLE ACCESS	NO	NO	NO	NO	NO	NO	NO

# CONFERENCE ROOMS

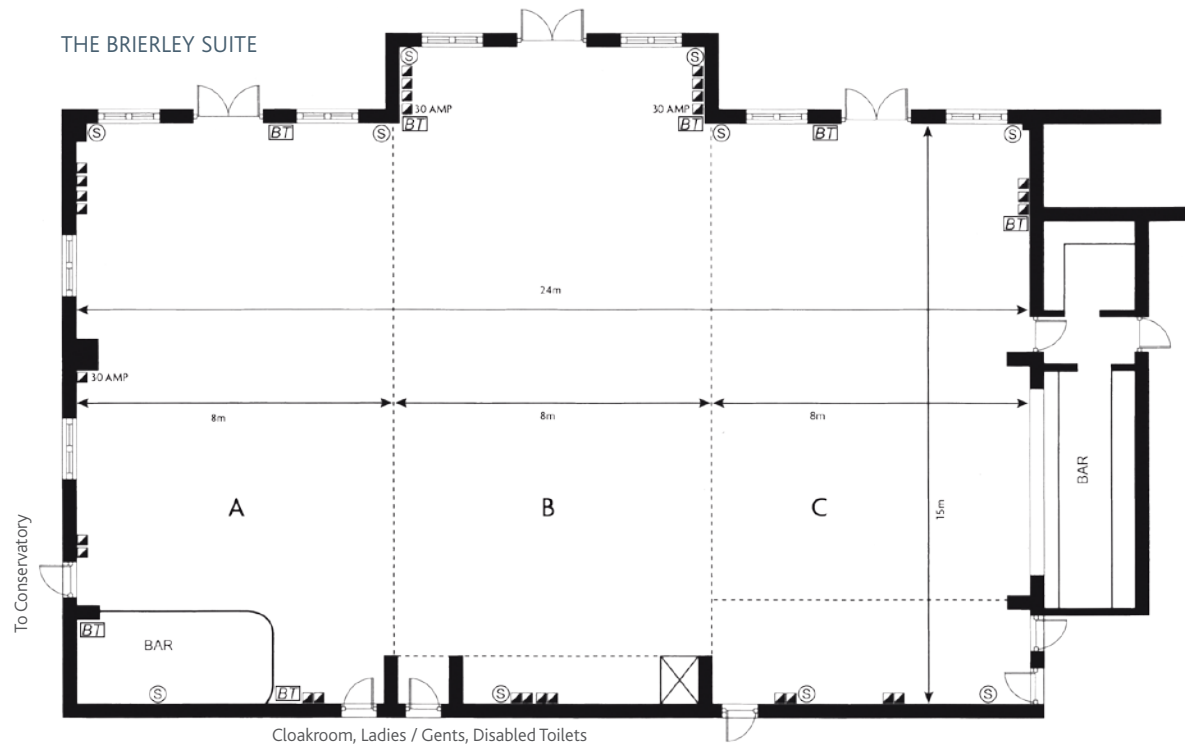

**CONFERENCE ROOM 1**

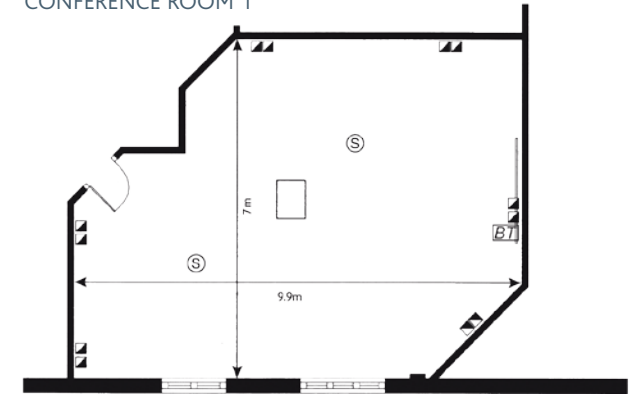

**CONFERENCE ROOM 2**

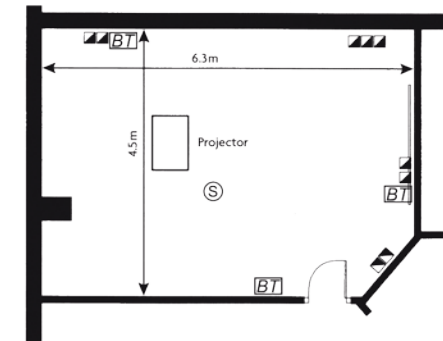

**CONFERENCE ROOM 4+5**

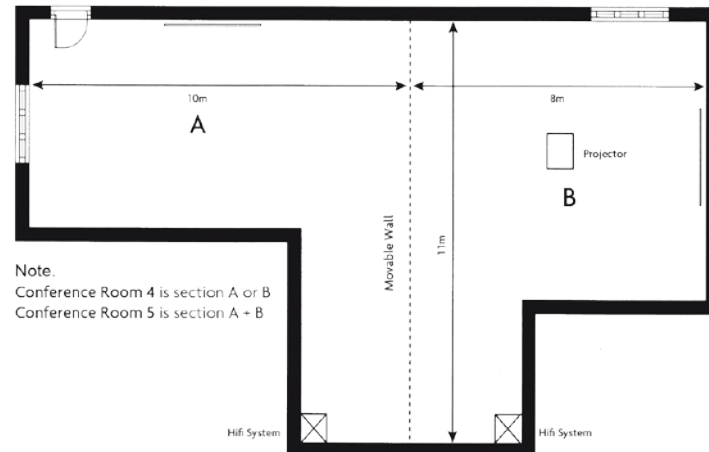

Note.  
Conference Room 4 is section A or B  
Conference Room 5 is section A + B

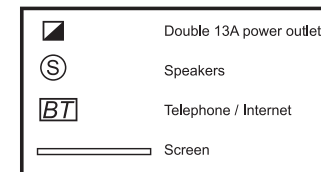

NOTE:

**Houghton Room 4** is sections A+B or B+C of Brierley Suite  
**Carlton Room** is section A or C of Brierley Suite